

NPN Transistors

■ Features

- Low collector-to-emitter saturation voltage.
- Large current capacity and wide ASO.
- Fast switching speed.
- Complementary to 2SB1123_U

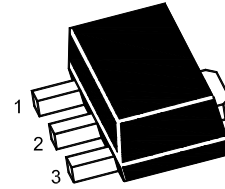

1.Base 2.Collector 3.Emitter
SOT-89 Plastic Package

■ Absolute Maximum Ratings Ta = 25°C

Parameter	Symbol	Rating	Unit
Collector - Base Voltage	V _{CB0}	60	V
Collector - Emitter Voltage	V _{CEO}	50	
Emitter - Base Voltage	V _{EB0}	6	
Collector Current - Continuous	I _C	2	A
Collector Current - Pulse	I _{CP}	4	
Collector Power Dissipation (Note.1)	P _C	0.5	W
		1.3	
Junction Temperature	T _J	150	°C
Storage Temperature Range	T _{stg}	-55 to 150	

Note.1: Mounted on ceramic board (250mm² × 0.8mm)

■ Electrical Characteristics Ta = 5°C

Parameter	Symbol	Test Conditions	Min	Typ	Max	Unit
Collector- base breakdown voltage	V _{CB0}	I _C = 100 uA, I _E = 0	60			V
Collector- emitter breakdown voltage	V _{CEO}	I _C = 1 mA, R _{BE} = ∞	50			
Emitter - base breakdown voltage	V _{EB0}	I _E = 100 uA, I _C = 0	6			
Collector-base cut-off current	I _{CB0}	V _{CB} = 50 V, I _E = 0			0.1	uA
Emitter cut-off current	I _{EB0}	V _{EB} = 4V, I _C =0			0.1	
Collector-emitter saturation voltage	V _{CE(sat)}	I _C =1 A, I _B =50 mA		0.15	0.4	V
Base - emitter saturation voltage	V _{BE(sat)}	I _C =1 A, I _B =50 mA		0.9	1.2	
DC current gain	h _{FE}	V _{CE} = 2V, I _C = 100 mA	100		560	
		V _{CE} = 2V, I _C = 1.5 A	40			
Turn-ON Time	t _{on}	See specified Test Circuit.		60		ns
Storage Time	t _{stg}			550		
Fall Time	t _f			30		
Collector output capacitance	C _{ob}	V _{CB} = 10V, I _E = 0, f=1MHz		12		pF
Transition frequency	f _r	V _{CE} = 10V, I _C = 50mA		150		MHz

■ Classification of h_{FE}(1)

Type	2SD1623-R	2SD1623-S	2SD1623-T	2SD1623-U
Range	100-200	140-280	200-400	280-560
Marking	DF R	DF S	DF T	DF U

Switching Time Test Circuit

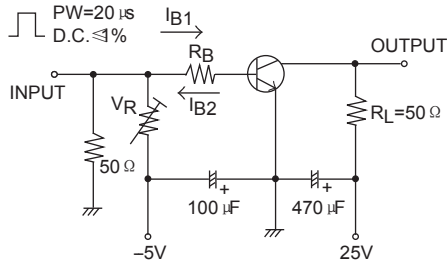

$I_C = 10I_{B1} = -10I_{B2} = 500\text{mA}$
(For PNP, the polarity is reversed)

■ Typical Characteristics

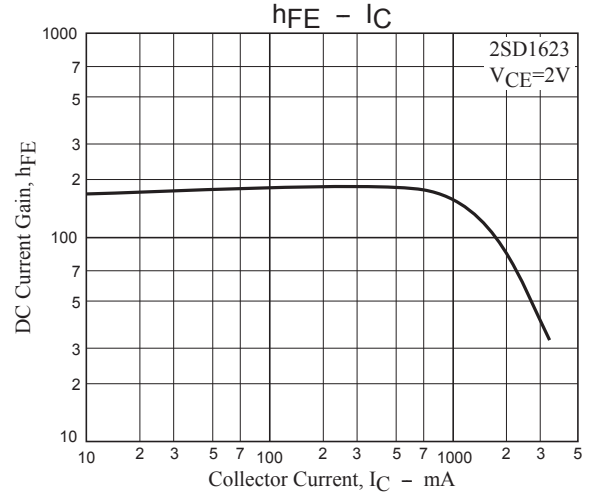
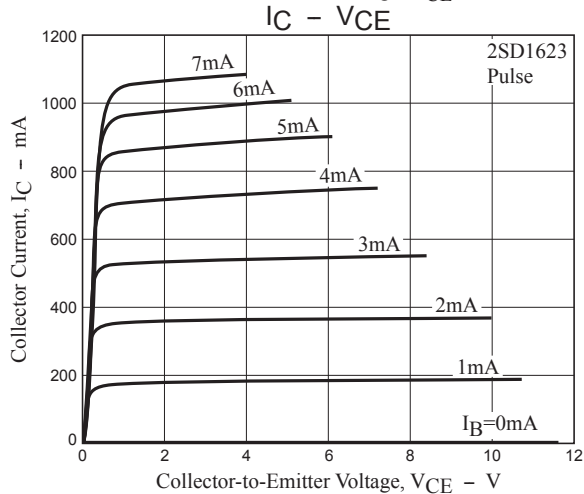
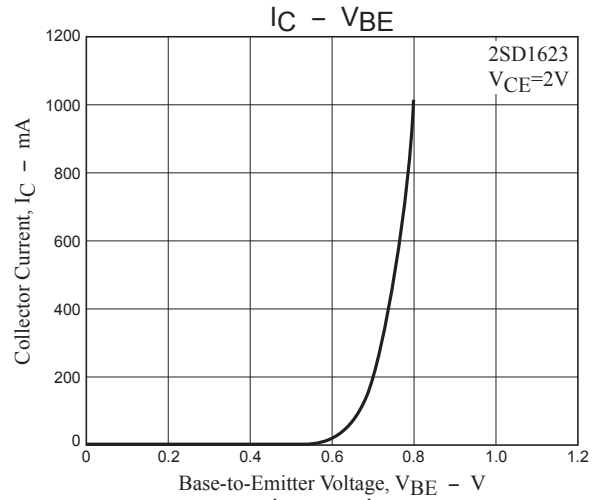
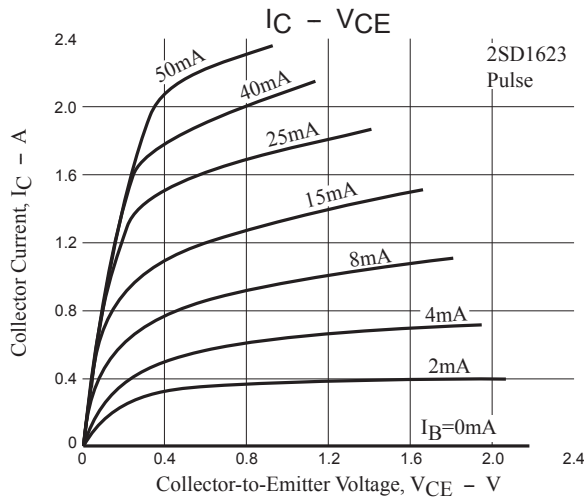

■ Typical Characteristics

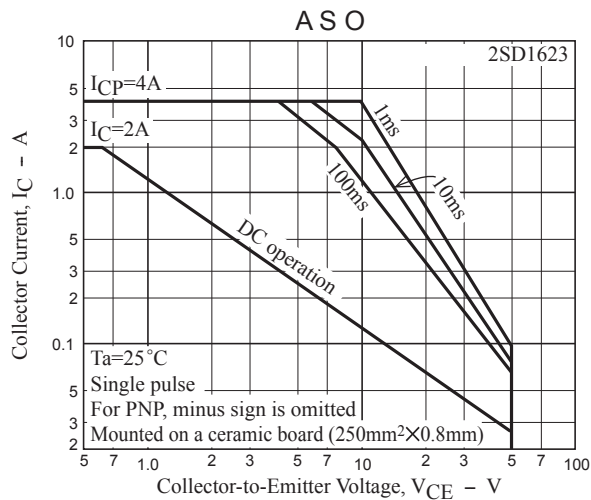
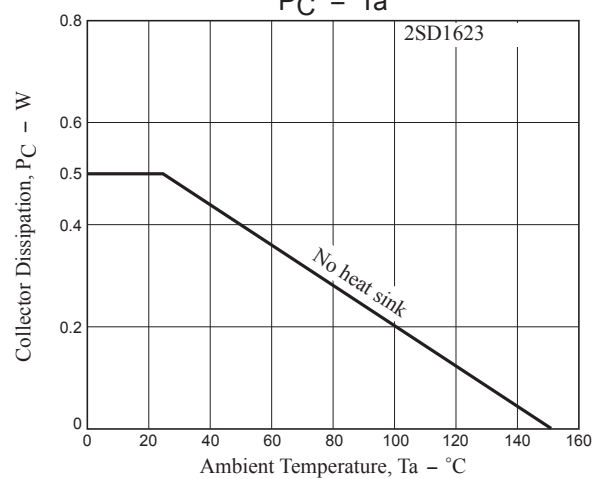
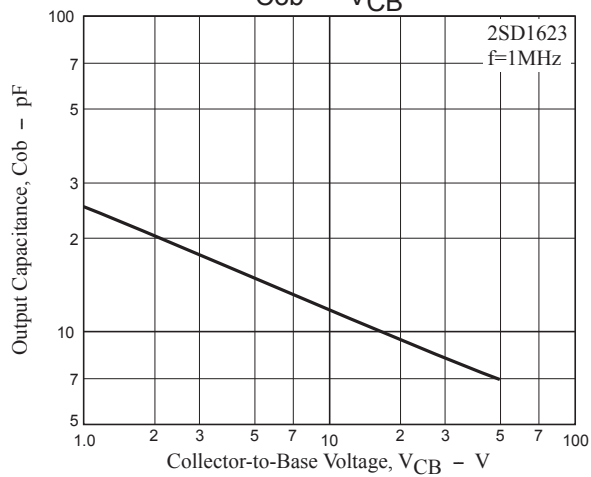
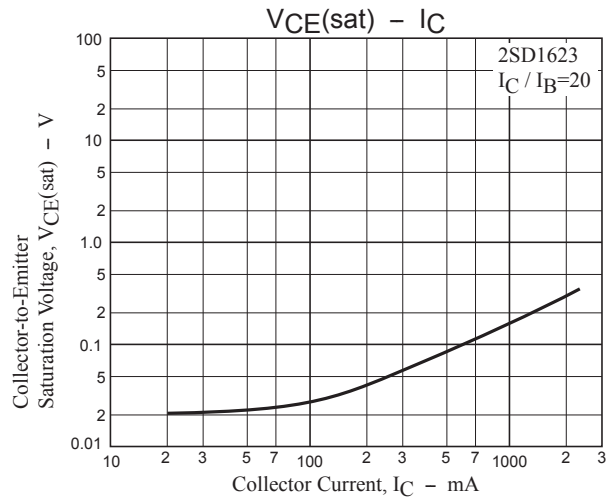
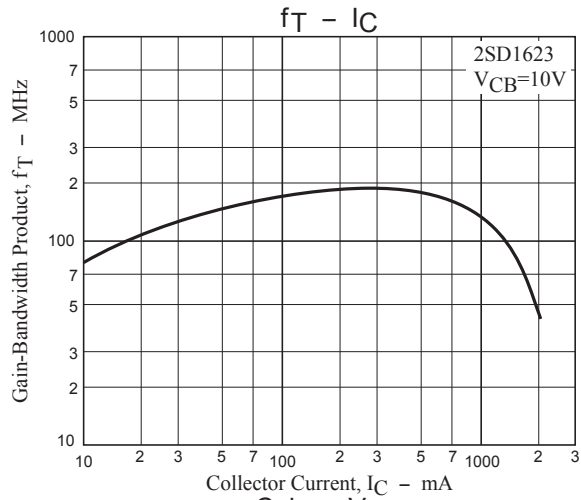



CHINA BASE
INTERNATIONAL

SOT-89

2SD1623U



www.china-base.com.hk

SOT-89 PACKAGE OUTLINE

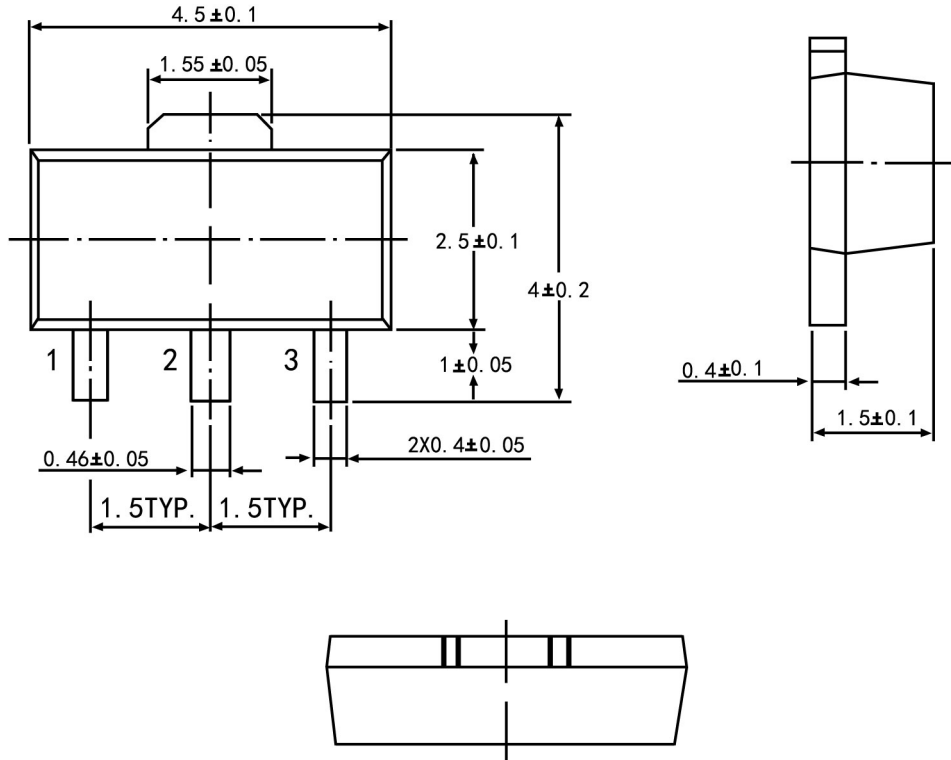

Symbol	Dimension in Millimeters	
	Min	Max
A	1.40	1.60
B	0.44	0.62
B1	0.35	0.54
C	0.35	0.44
D	4.40	4.60
D1	1.62	1.83
E	2.29	2.60
e	1.50 Typ	
H	3.94	4.25
H1	2.63	2.93
L	0.89	1.20
All Dimensions In mm		